

Dual AS-12A Package PSA Oxygen Generator

Specifications

Product Characteristics

Standard Product Flow: 24 SCF/hr¹ (0.63 Nm³/hr²)
Standard Product Pressure: 0–18 psig (0–124 kPa)
Minimum Product Purity: 90%
Product Dew Point: -100°F (-73°C)

Ambient Operating Conditions

Locate the oxygen generator in a well-ventilated area that is protected from weather elements and remains between 40°F (4°C) and 112°F (44°C)

Control Power Requirements

120 V ~ ±10%, 50/60 Hz, Single Phase, 8 A
220 V ~ ±10%, 50/60 Hz, Single Phase, 4 A
Typical Power Consumption (at 90% purity): 700 W

Physical Characteristics

Dimensions (W x D x H): 45 x 20 x 48 in.
(114 x 51 x 122 cm)

Weight: 290 lb. (132 kg)

Physical Connections

Product Gas Outlet: 1/8" FPT off pressure regulator

Warranty: 1 Year Parts and Factory Labor*

*An unprotected or inadequately ventilated environment or improper control power may cause damage to the oxygen generator not covered under warranty.

AirSep Corporation continually improves its products and reserves the right to change specifications or design without notice.

Oxygen Generators manufactured by the Commercial Products Division of AirSep Corporation are sold for use in industrial applications only. Contact AirSep Corporation or an authorized AirSep representative before purchasing a unit for any medical application.

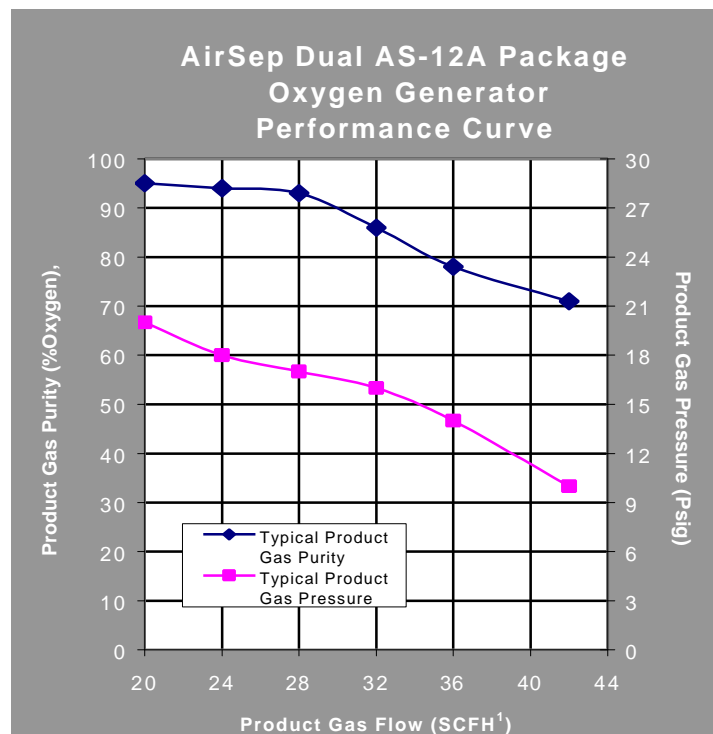

Note: A standard Dual AS-12A Package delivers 24 SCF/hr¹ (0.63 Nm³/hr²) of 90% minimum purity oxygen at a pressure of 18 psig (124 kPa). Generator performance will vary slightly in accordance with ambient air temperature and site conditions.

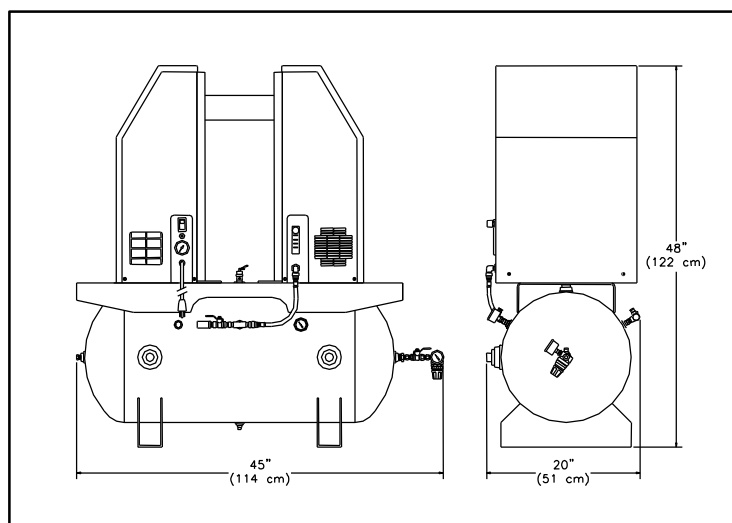

¹ SCF (Standard cubic foot) gas measured at 1 atmosphere and 70°F

² Nm³ (Normal cubic meter) gas measured at 1 atmosphere and 0°C